

# THUNDERBIRD YACHTS



  
Y A C H T S

[www.thunderbirdyachts.com](http://www.thunderbirdyachts.com), [www.phoenixyachts.com](http://www.phoenixyachts.com), [www.ghiyachts.com](http://www.ghiyachts.com)

E: [ghigroup@daum.net](mailto:ghigroup@daum.net)

T: +82-61-464-0906 F: +82-61-464-0790





## FLY LIKE AN EAGLE ON THUNDERBIRD

One word: THUNDERBIRD! Rise to the occasion at sea on bold, ruggedly-stylish, luxury yachts. Available as a fast, semi-displacement motoryacht or a full-displacement bluewater explorer, Thunderbird is manufactured in aluminum alloy AL 5083 at GHI Yachts, South Korea's superyacht shipyard.

Designed in Rome, Italy by Borzelli & Berta Architects with naval architecture and marine engineering by Francesco Rogantin, Thunderbird's full displacement explorers range 65 to 125-feet. A flexible general arrangement allows interior design customized with the owner's vision.

### Yacht owner's vision, input direct a custom yacht interior

Incorporating the yacht owner's creative vision with the yacht designer's perspective is a hallmark of the Thunderbird series, creating a truly custom yacht interior with expertly installed Italian furnishings of the highest quality. Building in aluminum also provides the opportunity to customize exterior profile features in context with the owner's aspirations for finesse, power and performance.

### South Korea: The world's #1 shipbuilding nation

The Republic of Korea surpassed China as the world's top shipbuilding nation. South Korea represents an international heritage of high quality with production efficiency for an exceptional value in world manufacturing sectors for consumer and industrial products. Decades of shipbuilding expertise and fine craftsmanship combined with high-quality, luxurious Italian yacht design defines every Thunderbird, from a sleek, sporty, contemporary style with a deep Vee hull to stouter and even bolder full-displacement explorer yachts.

THUNDERBIRDYACHTS.COM



*Rise to the occasion*

THUNDERBIRD 130 CARRIER



THUNDERBIRD 100

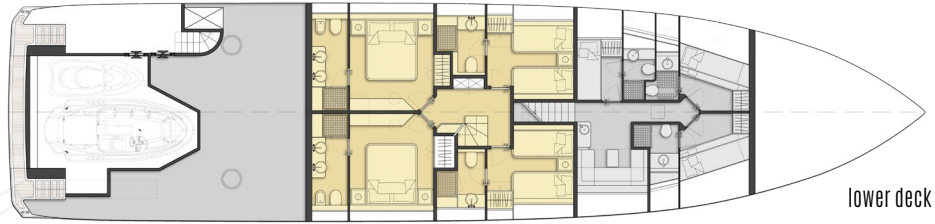
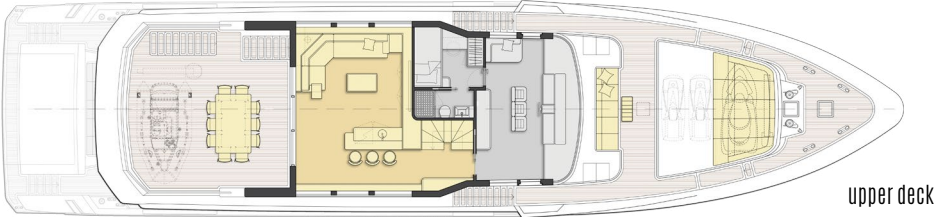
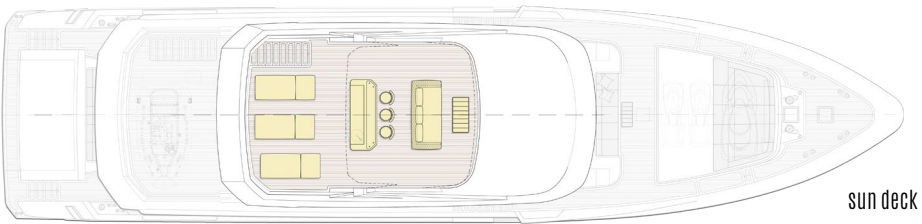

DECKS & SPECS | THUNDERBIRD 100



LENGTH OVERALL	100'	30.5 m
LENGTH OF WATERLINE	89.2'	27.2 m
BEAM*	26'	8 m
DRAFT	6'6"	2.2 m
DISPLACEMENT FULL LOAD (est.)	190 tons	
FUEL CAPACITY	9,246 gal	35,000 L
FRESH WATER	2,113 gal	8,000 L
MAIN ENGINES	2x MTU 2 X 1001HP	
SPEED, MAX (SEA TRIALS CONDITION)	16 kn	
SPEED, CRUISE (SEA TRIALS CONDITION)	14 kn	



## THUNDERBIRD 130 CARRIER

Call the Chopper! When a simple tender won't suffice to ferry you to your floating palace, the Thunderbird Carrier is outfitted for adventurous expeditions and exploration. Bring blue seas and true escape a little bit closer, with a helipad for your private helicopter.



## Action, adventure aboard Thunderbird Carrier 130

Lavishly designed with two pools, fore and aft, your Carrier is a floating helipad accommodating every conceivable high-performance water toy for action and adventure with special tender garages.





The Carrier is defined by a formidably-rugged, square bow, integrating a superyacht and a support ship into one, luxurious vessel.

Measuring 40 meters, ample deck and storage space carries all tenders, toys and additional equipment any adventure could need, Jet Skis, quad bikes, or outfitted for a submarine garage, or dive equipment.

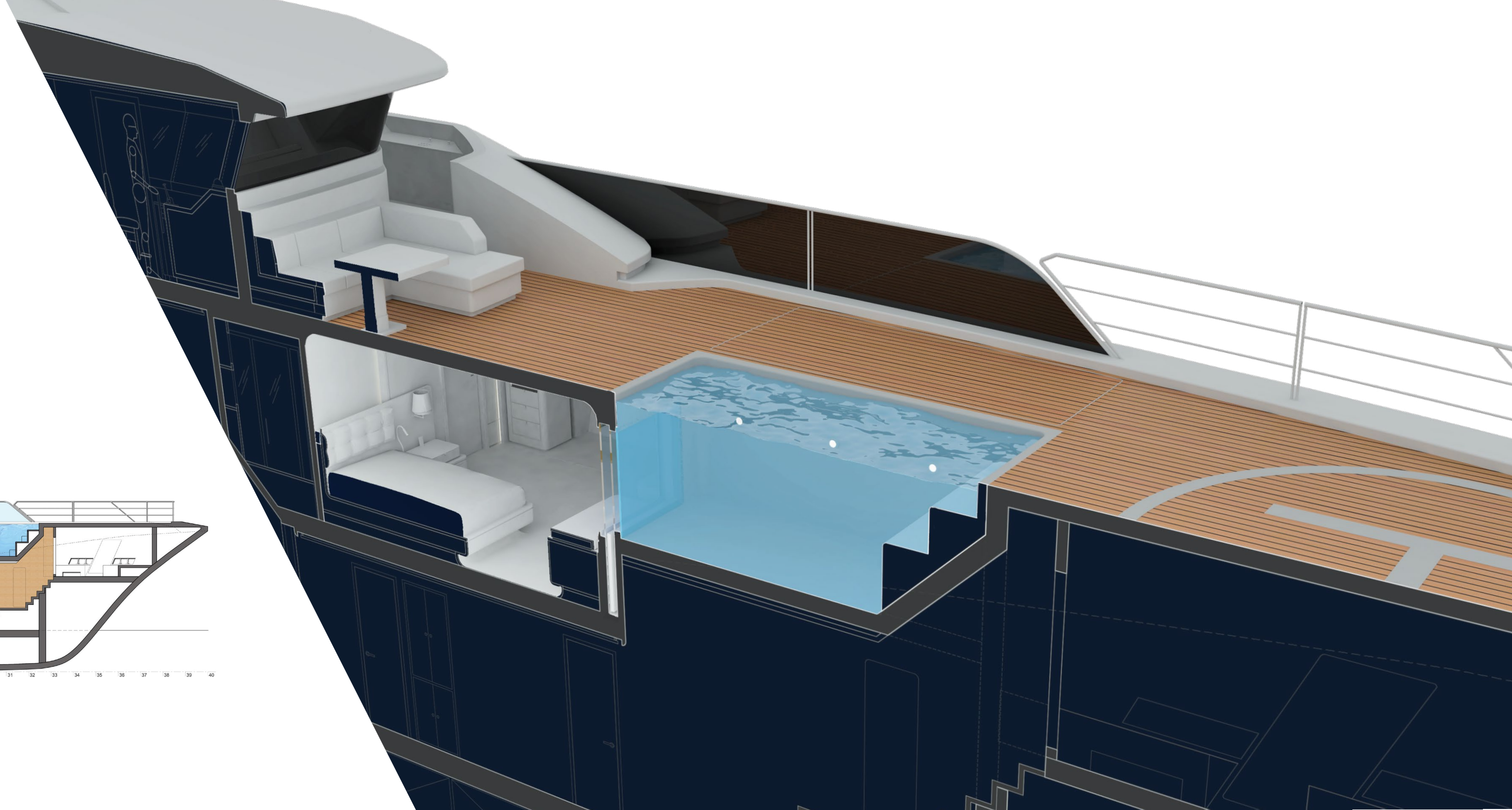



DECKS & SPECS | THUNDERBIRD 130 CARRIER



LENGTH OVERALL	130'	40 m
LENGTH OF WATERLINE	112.8'	34.4 m
BEAM*	26.2'	8 m
DRAFT	6'	1.85 m
DISPLACEMENT FULL LOAD (est.)	250 tons	
FUEL CAPACITY	13,209 gal	50,000 L
FRESH WATER	2,119 gal	8,400 L
MAIN ENGINES	2x MTU 16V2000 M84 2 x 1630 kW @ 2450 rpm	
SPEED, MAX (SEA TRIALS CONDITION)	18 kn	
SPEED, CRUISE (SEA TRIALS CONDITION)	16.5 kn	



upper deck



main deck



lower deck





## THUNDERBIRD 130



## South Korea: exceptional value with high quality manufacturing

This semi-displacement yacht with an aluminum hull and superstructure is designed by Borzelli & Berta of Italy and built at GHI Yachts, South Korea's superyacht shipyard. Korean shipyards, represented by Hyundai, Samsung and Daewoo, provide a huge capacity of the world's commercial vessels.





DECKS & SPECS | THUNDERBIRD 130



LENGTH OVERALL	130'	40 m
LENGTH OF WATERLINE	111.5'	34 m
BEAM*	26.9'	8.2 m
DRAFT	13.6"	4.15 m
DISPLACEMENT FULL LOAD (est.)	30 tons	
FUEL CAPACITY	13,209 gal	50,000 L
FRESH WATER	2,000 gal	8,000 L
MAIN ENGINES	2x MTU 16V200 M96L 2 x 1939 kW @ 2450 rpm	
SPEED, MAX (SEA TRIALS CONDITION)	23 kn	
SPEEDCRUISE (SEA TRIALS CONDITION)	19 kn	

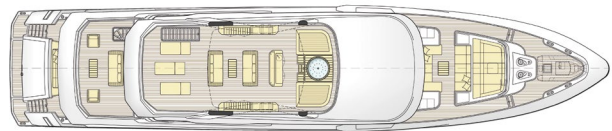

sun deck



upper deck



main deck



lower deck



THUNDERBIRDYACHTS.COM



## THUNDERBIRD 150



## GHI Yachts: decades of shipbuilding expertise and efficiency

GHI originally manufactured 70 to 180 meter commercial vessels but is now dedicated to producing Korea's first line of luxury superyachts. GHI Yachts brings decades of shipbuilding expertise, fine craftsmanship, high quality and great efficiency.

The Thunderbird series is a stylish and revolutionary line of vessels. Engaging an Italian yacht design team to produce modular, high-quality interiors in Italy to be installed in South Korea presents exceptional value for today's yachtsman





DECKS & SPECS | THUNDERBIRD 150



LENGTH OVERALL	150'	45 m
LENGTH OF WATERLINE	126'	38.45 m
BEAM*	27.8'	8.5 m
DRAFT	7.2'	2.2 m
DISPLACEMENT FULL LOAD (est.)	300 tons	
FUEL CAPACITY	13,209 gal	50,000 L
FRESH WATER	2,642 gal 10,000 L	
MAIN ENGINES	2x MTU 12V400 M96L 2 x 2580 kW @ 2100 rpm	
SPEED, MAX (SEA TRIALS CONDITION)	24 kn	
SPEED, CRUISE (SEA TRIALS CONDITION)	20 kn	

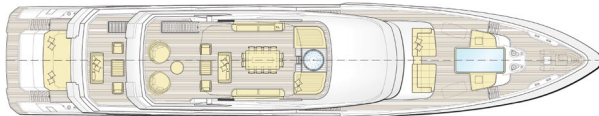

sun deck



upper deck



main deck



lower deck



THUNDERBIRDYACHTS.COM



## THUNDERBIRD 165



## Lightening on the water

Borzelli & Berta's classic Italian yacht design conceived the Thunderbird series with impeccable style and sleek lines for a bold profile.

In semi and full displacement hulls ranging 43 to 170-feet, Thunderbird Yachts are personally built for the yacht owner, designed with flexible general arrangements and interior design customized to the owner's wishes and aspirations.

The interior layout and design incorporates the vision of the yacht owner with the yacht designer's imagination for a truly custom yacht interior with the highest Italian quality and materials, built at GHI Yachts, South Korea's Superyacht Shipyard.



DECKS & SPECS | THUNDERBIRD 165



LENGTH OVERALL	165'	50 m
LENGTH OF WATERLINE	141'	43 m
BEAM*	26.2'	8.8 m
DRAFT	7.3"	2.25 m
DISPLACEMENT FULL LOAD (est.)	390 tons	
FUEL CAPACITY	14,529 gal	55,000 L
FRESH WATER	3,963 gal	15,000 L
MAIN ENGINES	2 x MTU 16V4000 M93L 2 x 3900 kW @ 2100 rpm	
SPEED, MAX (SEA TRIALS CONDITION)	26 kn	
SPEEDCRUISE (SEA TRIALS CONDITION)	22 kn	

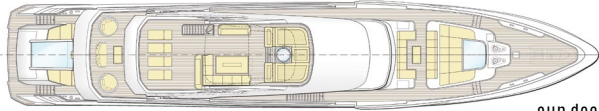

sun deck



upper deck



main deck



lower deck



THUNDERBIRDYACHTS.COM





Fly like an eagle on Thunderbird’s full displacement explorer line offered in aluminum from 65 -125-feet.

Designed by Borzelli & Berta and built at GHI Yachts, South Korea’s superyacht shipyard, Thunderbird Explorers offer a stout, robust, full-displacement explorer with incredible lines and seakeeping capabilities at every size range.

With a flexible general arrangement, the interior layout and design incorporates the visions of the yacht owner with the yacht designer for a truly custom yacht interior with the highest Italian quality, built in the Republic of Korea at GHI Yachts, South Korea's Superyacht Shipyard.



THUNDERBIRDYACHTS.COM

## THUNDERBIRD EXPLORER 65

LENGTH OVERALL	65’	20.5 m
LENGTH OF WATERLINE	65’	18.9 m
BEAM*	19’	5.8 m
DRAFT	5.9’	1.8 m
DISPLACEMENT FULL LOAD (est.)	85 tons	
FUEL CAPACITY	3,170 gal	12,000 L
FRESH WATER	343 gal	1,300 L
MAIN ENGINES	2 x John Deere 6068SFM85 355 bhp @ 2,700 rpm	
SPEED, MAX (SEA TRIALS CONDITION)	11.5 kn	
SPEED, CRUISE (SEA TRIALS CONDITION)	10 kn	

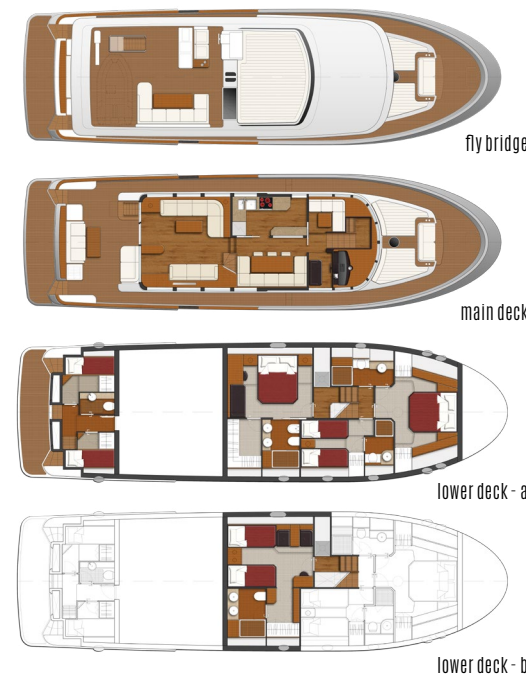

## THUNDERBIRD EXPLORER 65 - 4 CABINS

LENGTH OVERALL	65’	20.5 m
LENGTH OF WATERLINE	65’	18.9 m
BEAM*	19’	5.8 m
DRAFT	5.9’	1.8 m
DISPLACEMENT FULL LOAD (est.)	85 tons	
FUEL CAPACITY	3,170 gal	12,000 L
FRESH WATER	343 gal	1,300 L
MAIN ENGINES	x John Deere 6068SFM85 355 bhp @ 2,700 rpm	
SPEED, MAX (SEA TRIALS CONDITION)	11.5 kn	
SPEED, CRUISE (SEA TRIALS CONDITION)	10 kn	

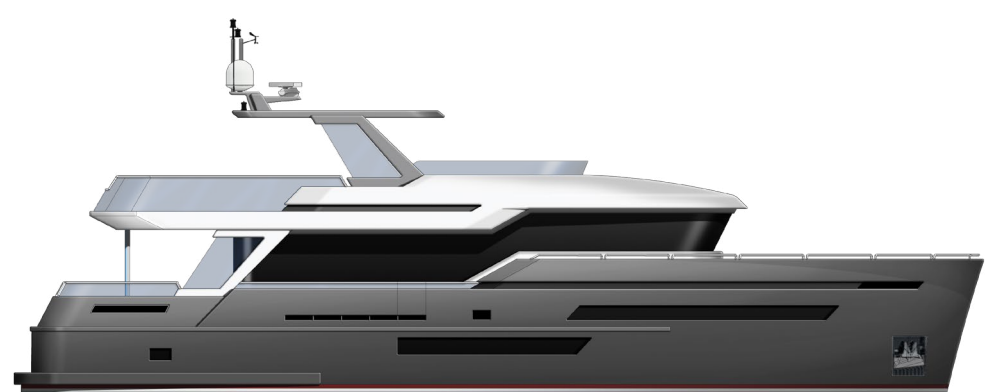
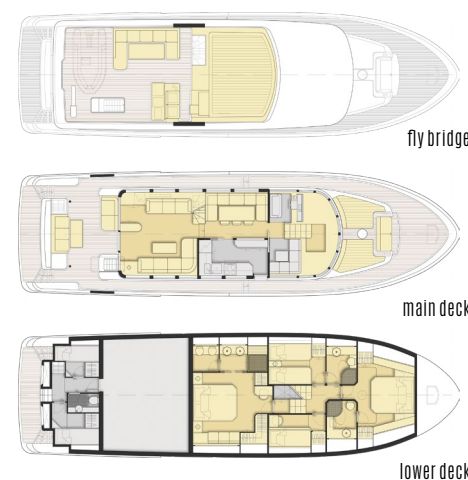



THUNDERBIRD EXPLORER 72

LENGTH OVERALL	72'	22.2 m
LENGTH OF WATERLINE	60.9'	20.3 m
BEAM*	18.6'	6.2 m
DRAFT	5.5'	1.85 m
DISPLACEMENT FULL LOAD (est.)	110 tons	
FUEL CAPACITY	4,490 gal	17,000 L
FRESH WATER	343 gal	1,300 L
MAIN ENGINES	2 x John Deere 6068SFM85 355 hp @ 2,700 rpm	
SPEED, MAX (SEA TRIALS CONDITION)	11.5 kn	
SPEED, CRUISE (SEA TRIALS CONDITION)	10 kn	



THUNDERBIRD EXPLORER 78

LENGTH OVERALL	78'	23.75 m
LENGTH OF WATERLINE	71.5'	21.8 m
BEAM*	21.6'	6.6 m
DRAFT	6.23'	1.9 m
DISPLACEMENT FULL LOAD (est.)	150 tons	
FUEL CAPACITY	5,547 gal	21,000 L
FRESH WATER	660 gal	2,500 L
MAIN ENGINES	2 x John Deere 6090AFM85 425 hp @ 2,400 rpm	
SPEED, MAX (SEA TRIALS CONDITION)	11.5 kn	
SPEED, CRUISE (SEA TRIALS CONDITION)	10 kn	



THUNDERBIRD EXPLORER 82

LENGTH OVERALL	82'	25.2 m
LENGTH OF WATERLINE	72.7'	22.16 m
BEAM*	22.3'	6.8 m
DRAFT	6.4'	1.95 m
DISPLACEMENT FULL LOAD (est.)	170 tons	
FUEL CAPACITY	6,604 gal	25,000 L
FRESH WATER	1056 gal	4,000 L
MAIN ENGINES	2 x Caterpillar C12 600 hp @ 2,300 rpm	
SPEED, MAX (SEA TRIALS CONDITION)	11.5 kn	
SPEED, CRUISE (SEA TRIALS CONDITION)	10 kn	

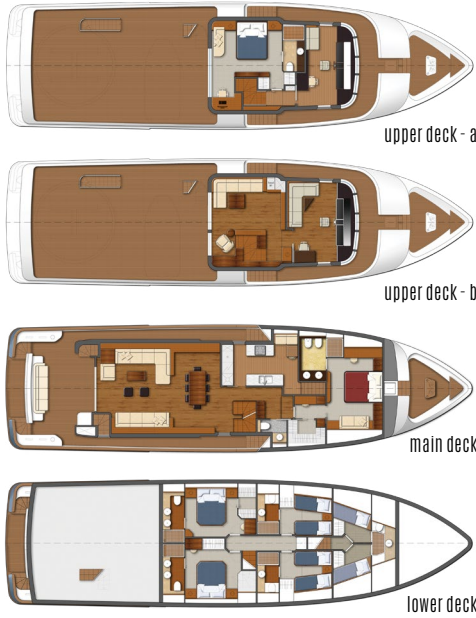

THUNDERBIRD EXPLORER 90

LENGTH OVERALL	90'	27.41 m
LENGTH OF WATERLINE	72.7'	22.16 m
BEAM*	23.9'	7.3 m
DRAFT	7.2'	2.2 m
DISPLACEMENT FULL LOAD (est.)	230 tons	
FUEL CAPACITY	8454 gal	32,000 L
FRESH WATER	1,849 gal	7,000 L
MAIN ENGINES	2 x Caterpillar C18 715 hp @ 2,100 rpm	
SPEED, MAX (SEA TRIALS CONDITION)	11.5 kn	
SPEED, CRUISE (SEA TRIALS CONDITION)	10 kn	

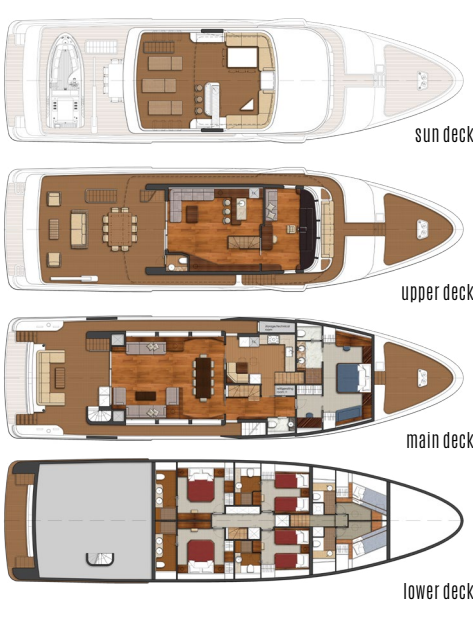



THUNDERBIRD EXPLORER 98

LENGTH OVERALL	98'	29.84 m
LENGTH OF WATERLINE	86.8'	26.45 m
BEAM*	24.2'	7.4 m
DRAFT	7.2'	2.2 m
DISPLACEMENT FULL LOAD (est.)	230 tons	
FUEL CAPACITY	10,566 gal	40,000 L
FRESH WATER	2,641 gal	10,000 L
MAIN ENGINES	2 x Caterpillar C18 803 hp @ 2,100 rpm	
SPEED, MAX (SEA TRIALS CONDITION)	12 kn	
SPEED, CRUISE (SEA TRIALS CONDITION)	11 kn	

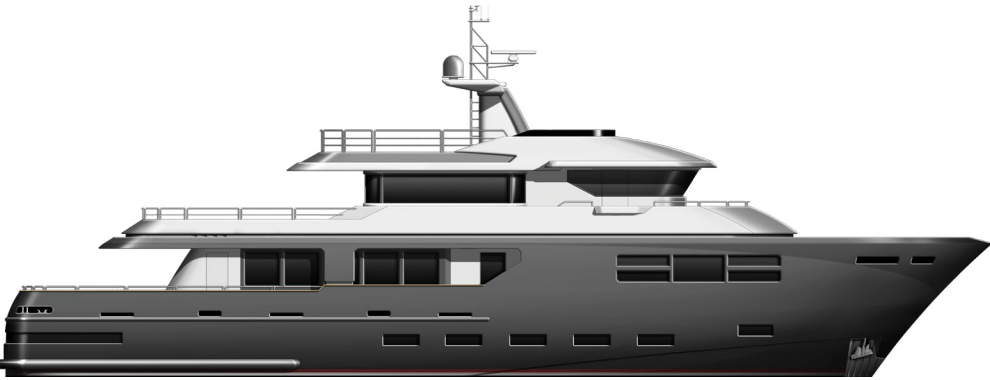
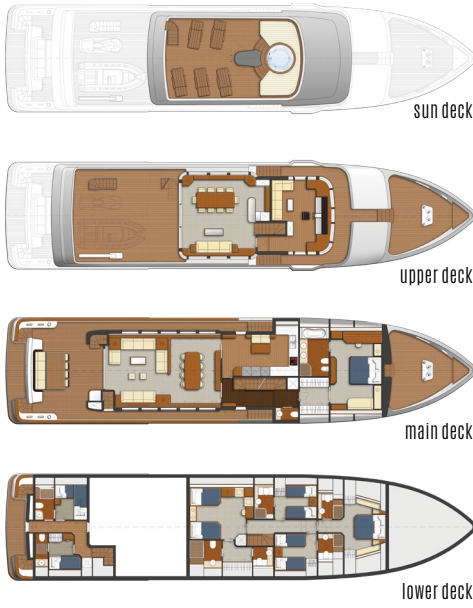

THUNDERBIRD EXPLORER 125

LENGTH OVERALL	125'	38.06 m
LENGTH OF WATERLINE	113'	34.4 m
BEAM*	26'	8 m
DRAFT	7.7'	2.35 m
DISPLACEMENT FULL LOAD (est.)	350 tons	
FUEL CAPACITY	13,208 gal	50,000 L
FRESH WATER	3,170 gal	12,000 L
MAIN ENGINES	2 x Caterpillar C18 1,000 hp @ 2,300 rpm	
SPEED, MAX (SEA TRIALS CONDITION)	13 kn	
SPEED, CRUISE (SEA TRIALS CONDITION)	11 kn	

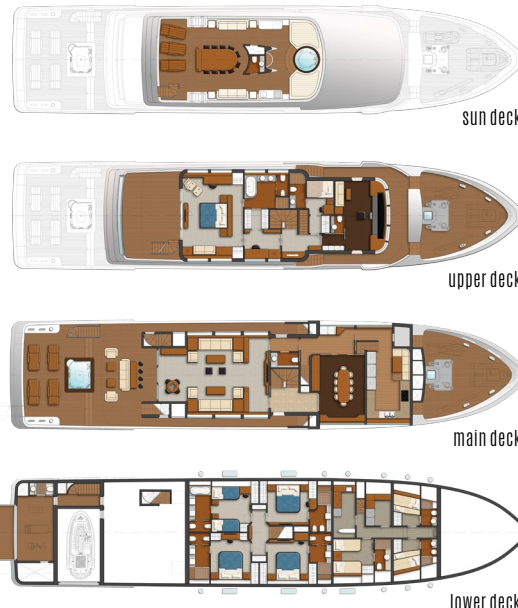

THUNDERBIRD EXPLORER 125 - 7 CABINS

LENGTH OVERALL	125'	38.06 m
LENGTH OF WATERLINE	113'	34.4 m
BEAM*	26'	8 m
DRAFT	7.7'	2.35 m
DISPLACEMENT FULL LOAD (est.)	350 tons	
FUEL CAPACITY	13,208 gal	50,000 L
FRESH WATER	3,170 gal	12,000 L
MAIN ENGINES	2 x Caterpillar C18 1,000 hp @ 2,300 rpm	
SPEED, MAX (SEA TRIALS CONDITION)	13 kn	
SPEED, CRUISE (SEA TRIALS CONDITION)	11 kn	

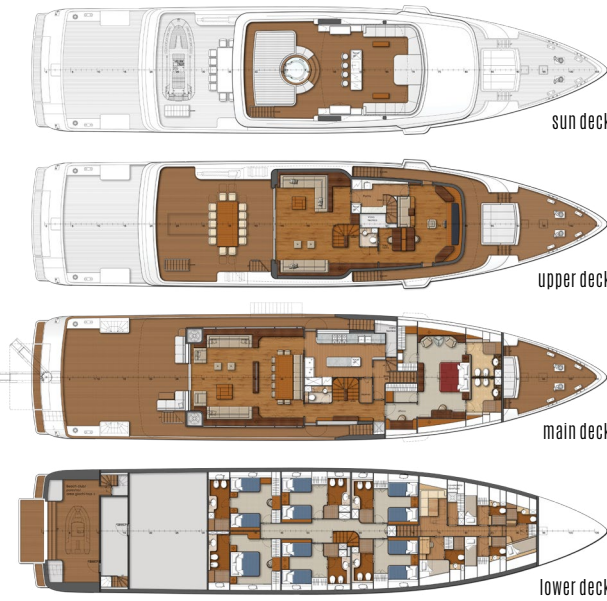

A new choice in aluminum for today’s yachtsman

GHI Yachts' shipbuilding expertise and efficiency, combined with Borzelli & Berta's classic Italian yacht design, presents the Thunderbird series as a serious choice for a yachtsman seeking impeccable production quality at an exceptional price with the highest standards.



THUNDERBIRDYACHTS.COM



TEAM THUNDERBIRD



**BORZELLI & BERTA**

Founded in 2007 by Andrea Borzelli and Sara Berta, with already a decade of experience in design and yachting, their design studio is committed in conceiving and realizing projects where aesthetics, innovation and functionality live together in perfect harmony, remembering the artisan and industrial tradition characterizing Italian Design.

Exceeding our customer’s expectations is the purpose of our work through constant innovation and special attention to every stage of the creative



**FRANCESCO ROGANTIN**

Francesco Rogantin is a naval architect and marine engineer based in Genoa, Italy. With numerous projects for Cantieri Navali Lavagna

and Hydro Tec to his credit, Francesco’s experience in hull design, performance prediction, weight calculations, hydrostatics and stability, technical specifications, structural/ hydraulic systems/outfitting design project management, classification societies and administration rules and shipyard production make Thunderbird series of semi displacement yachts and full displacement explorers a world class vessel series for today’s international yachtsman seeking a fast boat with a stout, seakeeping capabilities. His recent launches at Monaco Yacht Show 2019 include Tankoa 50 meter hybrid and ISA Extra 130 alloy.



**GHI SHIPYARD - BC BONGCHUL KIM**

BC Kim is one of South Korea’s most prominent naval architects and marine engineers.

GHI is a complete vessel manufacturing facility in the Republic of Korea, in the center of the northeast Asian Sea between China and Japan, the strategic gate to Eurasia.

This part of South Korea is well known for its boatbuilding innovation since the 16th century when Admiral Yi Sun-sin defeated a huge Japanese fleet. GHI was initially a naval shipyard and is immersed in heavy industry with steel and aluminum builds representing a combination of cutting-edge technology and

time-honored craftsmanship setting new standards in the quality of styling, performance and reliability. Now, GHI is building South Korea’s first superyacht, Phoenix 130, and has introduced Thunderbird series, a second aluminum line of fast semi displacement yachts and full displacement explorers.



**LAUDERDALE MARINE CENTER DOUG WEST**

Lauderdale Marine Center (LMC) is the US service and warranty center for GHI Yachts and its Phoenix and Thunderbird yacht series. As

Florida’s leading megayacht marina and shipyard, LMC is strategically located in the heart of Fort Lauderdale with a full roster of qualify technicians and subcontractors fulfilling every yacht punchlist or change order.



**JOHN OH GHI REPRESENTATIVE**

John Oh is a sales representative based in USA, California, representing GHI

Yachts to clients in the western United States and Canada.



**MEGAYACHT MEDIA LISA OVERING & JULIANNE RAINES**

Based in USA in Florida and North Carolina, Megayacht Media is a marketing and advertising agency for luxury and marine businesses,



providing complete branding, marketing, PR and website support for GHI Yachts and their line of Phoenix Yachts and Thunderbird Explorer Yachts.





THUNDERBIRDYACHTS.COM



Designed by

B O R Z E L L I  
& B E R T A

BORZELLI-BERTA.COM

**GHI**  
YACHTS

SOUTH KOREA'S  
SUPERYACHT  
SHIPYARD

GHIYACHTS.COM

Creative and marketing support for Thunderbird Yachts by

**MEGAYACHT MEDIA**  
copywriting • marketing • branding • social media • websites

MEGAYACHTMUSES.COM